

Shielded Rooms Series 100 Shielding Panel System

The Euroshield shielded rooms are of modular structure consisting of hot galvanized rigid steel panels which are bolted together by using a special gasket in the joints. No welding is necessary.

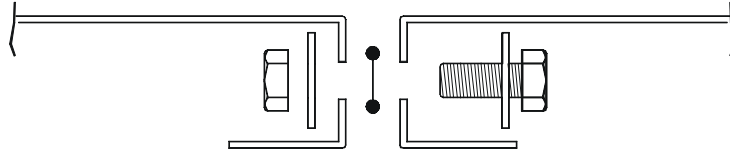

This modular prefab concept has originally been developed by Euroshield and it offers the flexibility necessary for designing customized enclosures while retaining the essential characteristics of a low number of component parts and easy assembly.

The Euroshield enclosures can easily be dismantled and re-mounted into a new place. It is also possible to enlarge the enclosure size using new panels, if the enclosure size in future turns out to be too small. Only the gaskets, bolts, nuts and washers must be replaced with new ones.

EUROSHIELD PANELS

Standard Euroshield RF-shielded rooms are made of hot-galvanized steel panels. For MRI-rooms, however, 2 mm thick aluminum is used instead.

Material : Hot galvanized steel plate
Thickness : 2 mm
Zinc layer : 275 g / m², thickness 20 μm

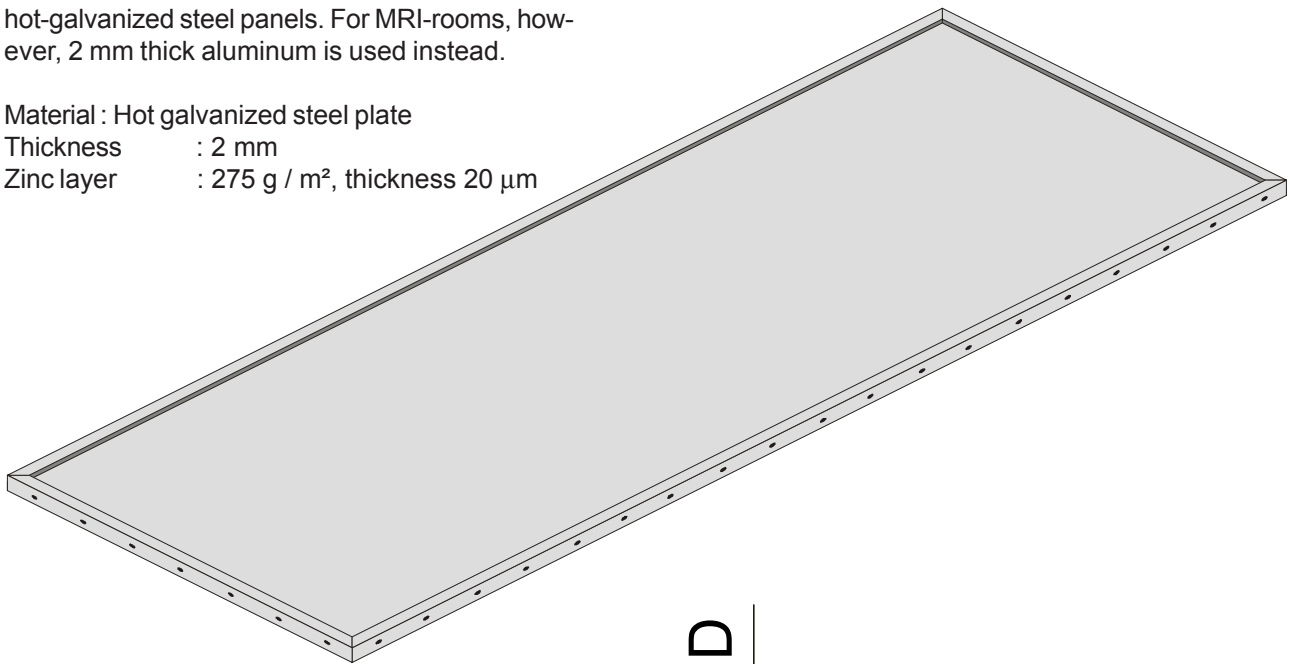

PANEL GASKET

The gasket used between the panels is copper clad, tin coated steel wire mesh. The thickness of the gasket in free form is 5 - 6 mm and when it is tightened between the panels it will be pressed down to 2 mm forming excellent conductivity between the panels.

Knitted mesh wire gasket
D = 5 - 6 mm
OA = approximately 19 mm

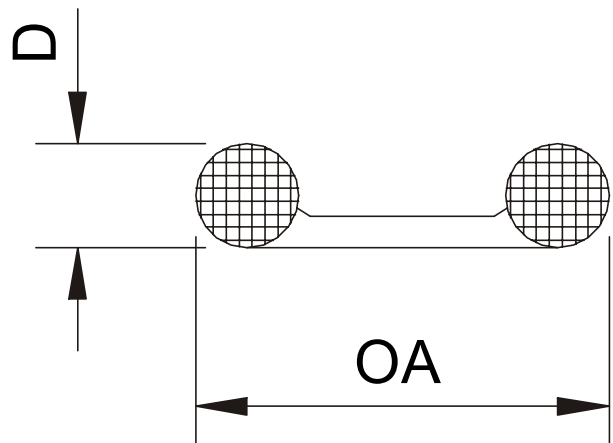

MODULAR SIZES OF PANELS

Euroshield standard shielding panels are based on a system of measurement modules. The nominal length and width of a panel are multiples of 160 mm. The nominal depth of a panel is 40 mm.

Please note that the nominal dimensions include the gasket, so the actual size of a panel is correspondingly smaller. The division of fastening bolts is also 160 mm (exact) as a standard.

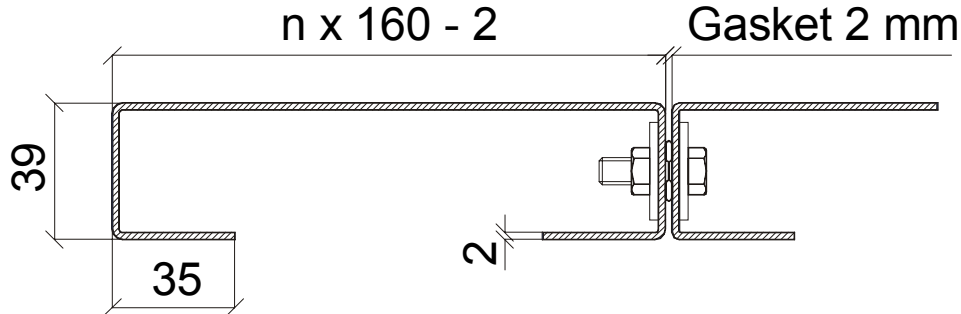

A standard panel size is 1120 mm x 3040 mm and the maximum size is 1120 mm x 4000 mm. For special purposes the panels can be tailor-made to any size and shape (non-standard treatment, e.g. welding might be required). Possible nominal lengths / widths in mm of a standard panel are:

- A = minimum length or width of a panel,
- B = maximum width of a panel,
- C = maximum length of a panel,
- D = minimum length of a standard door panel.

Length / width	160	320	480	640	800	960	1120	1280	1440	1600	1760	1920	2080	2240	2400	2560	2720	2880	3040	3200	3360	3520	3680	3840	4000	
	A						B							D												C

MODULAR SIZES OF ENCLOSURES

The standard external length and width of an enclosure are both multiples of 160 mm. For rooms higher than 3840 mm, the panels must be installed horizontally in rows on top of each other and a separate supporting construction is necessary. The panels are installed so that the vertical joints of

different rows do not meet each other. The total height of an enclosure is 80 mm greater than the height of the panels because of the depth of the floor and roof panels. Examples of the modular length / width and the total height of a standard design:

Length / width
... 3040 mm
3200 mm
3360 mm
3520 mm
3680 mm
3840 mm
4000 mm
4160 mm
4320 mm ...

Total height
... 2480 mm
2640 mm
2800 mm
...2960 mm
3120 mm
3280 mm
3440 mm
3600 mm
3760 mm ...

Because the total length / width of a standard enclosure is always a multiple of 160 mm, in standard design one panel in a row must be 40 mm (¼ module) narrower than the standard panels.

In general the exact construction of a standard Euroshield shielded room depends on the existing space, but in most cases the usage of as many standard panels as possible guarantees the best price / quality ratio.

ETS-Lindgren reserves the right to any change in this document without any further notice - 01/02